

# *the* OSBORNE



FOOD & BEVERAGE  
HEALTH & WELLNESS  
SPECIALTY RETAIL

PEACHTREE RD



BROOKHAVEN

HEALEY  
WEATHERHOLTZ  
PROPERTIES



# *in charming* **BROOKHAVEN**

Incredible visibility and signage opportunities on Peachtree Road.

Located in the heart of Brookhaven, one of Atlanta's most affluent and desirable neighborhoods.

**\$143,747**

**AVERAGE HOUSEHOLD  
INCOME**

3 mile radius

**14,683**

**POPULATION**

1 mile radius

**37,652**

**VEHICLES PER DAY**

PEACHTREE ROAD

**51,300 SF of RETAIL**



Saluzzo

YOGAHAUS



4210 & 4214 PEACHTREE RD



YOGAHAUS

YOGAHAUS

Saluzzo



4210 & 4214 PEACHTREE RD

 **Piedmont UrgentCare**  
BY *WellStreet*

 **BROOKHAVEN  
DENTAL**



4218 A & B PEACHTREE RD

niddo  
juiceria & salads



2665 OSBORNE RD



Miguel's  
RESTAURANT & BAR

the  
OSBORNE

2665 OSBORNE RD

GA -400 (143,906 VPD)

PEACHTREE ROAD (37,652 VPD)

# the OSBORNE

**BROOKHAVEN TOWN CENTER**

Costco Publix LA FITNESS Marshalls  
 tropical CAFE crumbl HOBNOB the Flying Biscuit Cafe  
 DressUp BIG PEACH M&M'S Ped Pepper taqueria

KALE OF CRAZY Souper Jenny

BROOKHAVEN PARK

**SHOPS AROUND LENOX**

Crate&Barrel west elm  
 lululemon athletica SOULCYCLE  
 FRAMEBRIDGE SUITSUPPLY  
 KENDRA SCOTT fab'rik  
 FLOWER CHILD SEVEN LAMPS

**PHIPPS PLAZA**

amc THEATRES Saks Fifth Avenue NORDSTROM ARHAUS  
 AC HOTELS NOBU HOTEL ecco MONSIEUR MARTINI

FOX BROS BAR-B-Q  
 mellow MUSHROOM  
 Total Wine & MORE  
 Kroger

SAVI PROVISIONS DIXIE Q verde HAVEN HOTWORX

Located along *Peachtree Road*, one of Atlanta's most recognizable thoroughfares, in *Brookhaven*, one of the most affluent and desirable parts of the city.

**LENOX MARKETPLACE**

TARGET Publix  
 DICK'S SPORTING GOODS IRON HILL BREWERY & RESTAURANT

**LENOX SQUARE**

Neiman Marcus bloomingdales macy's ZARA  
 Nike SEPHORA Apple sweetgreen  
 The Cheesecake Factory NORTH ITALIA SHAKE SHACK True Food kitchen



OSBORNE ROAD

Piedmont UrgentCare  
4218-A

CLEO  
BODYROK

2665

PEACHTREE ROAD  
(37,652 VPD)

BROOKHAVEN PARK



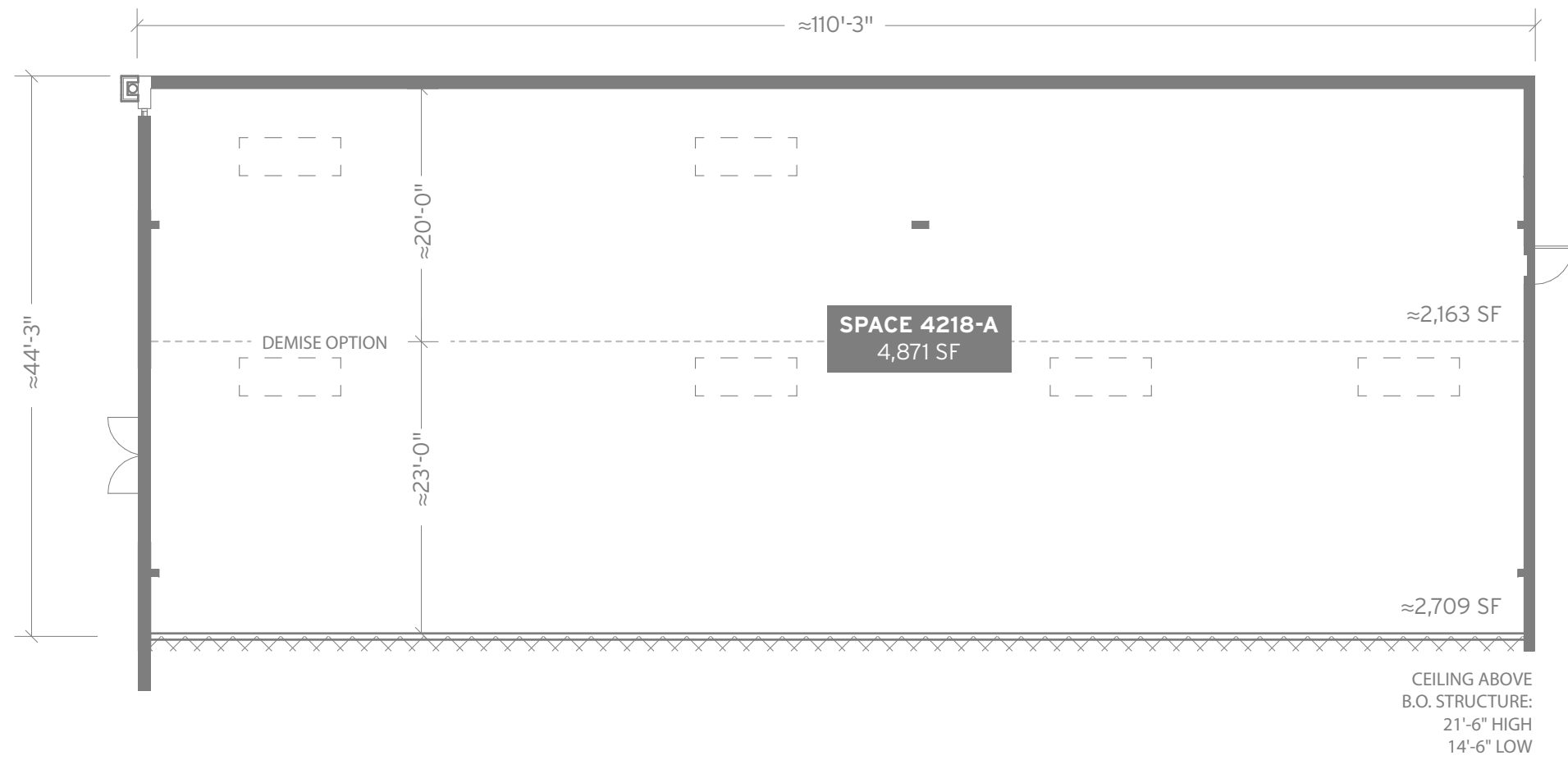
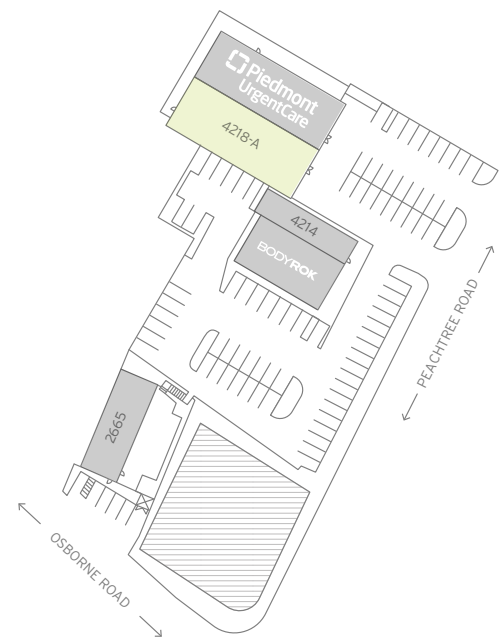

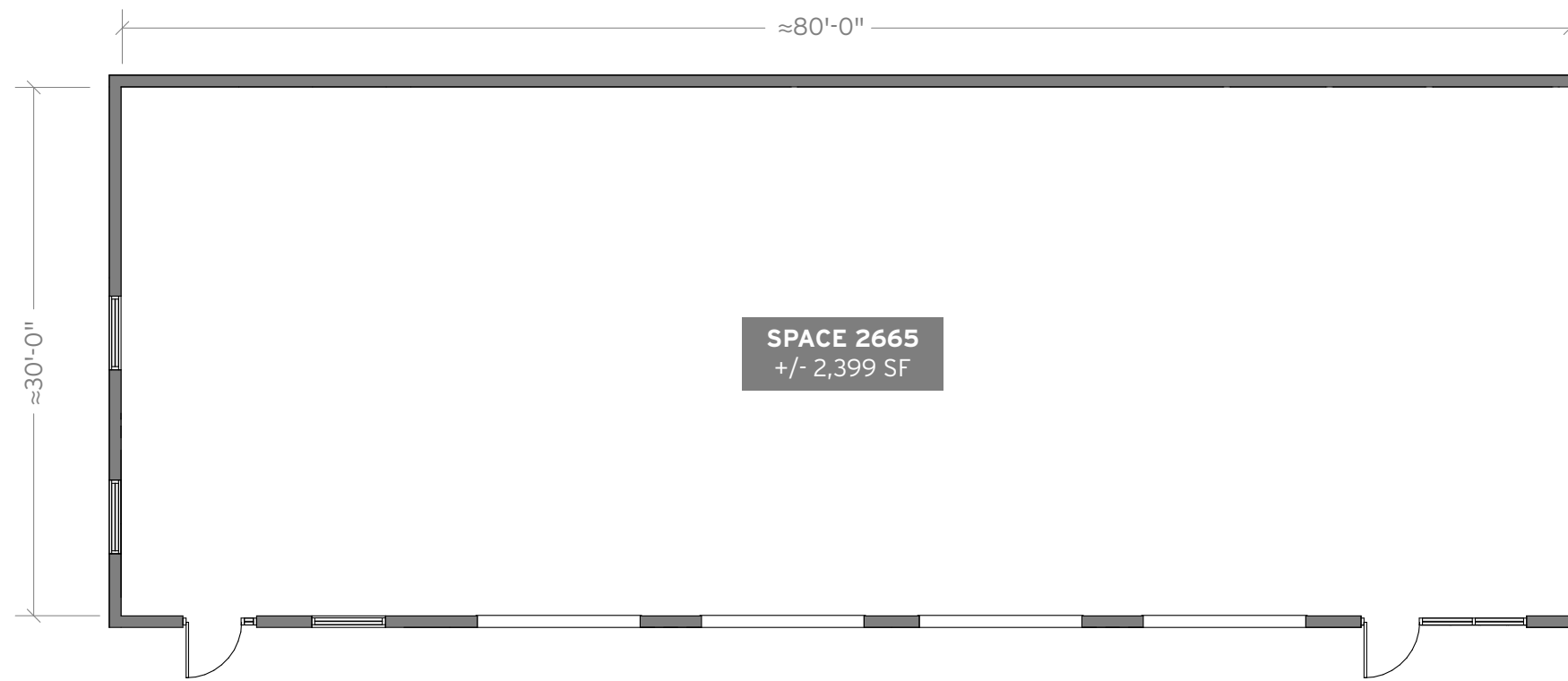
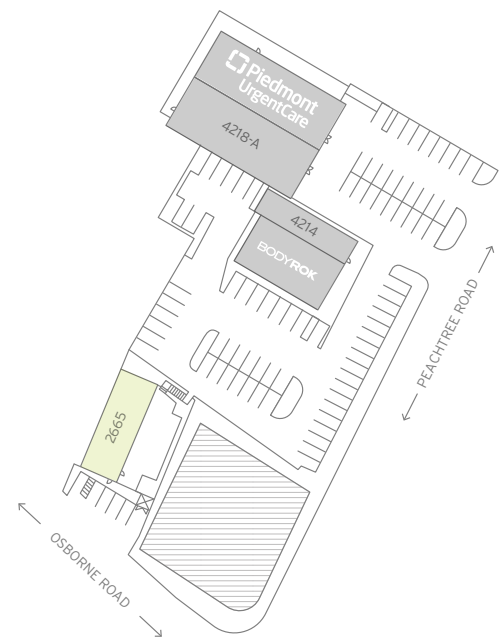

**the OSBORNE**

2665 PEACHTREE ROAD • BUCKHEAD • 30319

*The dimensions shown herein are for reference purposes only and are approximate. All measurements should be independently verified*



**COLEMAN WEATHERHOLTZ**

Partner, Leasing & Advisory  
coleman@hwproperties.com  
404-995-2409



**HEALEY  
WEATHERHOLTZ  
PROPERTIES**